

# Shell & Tube Heat Exchanger

## 4" Diameter Liquid to Liquid

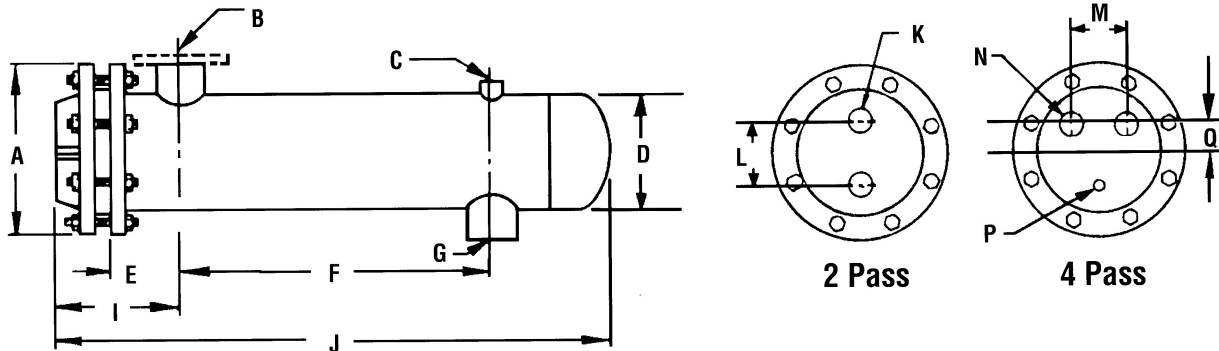

Model	A	B	C	D	E	F	G	I	J	K	L	M	N	P	Q
WW424(*)A	9	1 1/2 T	1/4	4 1/2	5	14 1/2	1 1/2 T	7 7/8	27 3/8	1 1/2	2 1/2	2 3/8	1 T	1/2	7/8
WW436(*)A		1 1/2 T				26 1/2	1 1/2 T		39 3/8						
WW448(*)A		1 1/2 T				38 1/2	1 1/2 T		51 3/8						
WW460(*)A		1 1/2 T				50 1/2	1 1/2 T		63 3/8						
WW472(*)A		1 1/2 T				62 1/2	1 1/2 T		75 3/8						
WW484(*)A		1 1/2 T				74 1/2	1 1/2 T		87 3/8						
WW496(*)A		1 1/2 T				86 1/2	1 1/2 T		99 3/8						
WW4108(*)A		1 1/2 T				98 1/2	1 1/2 T		111 3/8						

### Materials of Construction

Description	Standard	Optional
Head	4" - 10" Cast Iron 12" 20" Fabricated Steel	Bronze
Shell	Steel	—
Tubesheet	Steel	Bronze
Tubes	3/4" x 20" BGW Copper	90/10 CUNI
Baffles	Steel	Brass
Tie Rods and Spacers	Steel	Brass
Nuts and Bolts	Steel	—

### Maximum Operating Conditions

Tubeside	150 PSI
Shellside Working Pressure	150 PSI
Hydrostatic Test Pressure - Tubeside	300 PSI
Hydrostatic Test Pressure - Shellside	300 PSI
Maximum Temperature	375°F

Built in accordance with ASME Code Section VIII, Division I.

(\*) Indicates number of passes.

Dimensions are subject to change without notice, please confirm actual dimensions with factory at time of order.

JOB NAME \_\_\_\_\_  
 LOCATION \_\_\_\_\_  
 \_\_\_\_\_  
 \_\_\_\_\_  
 CONTRACTOR \_\_\_\_\_  
 CONTRACTOR P.O. NO. \_\_\_\_\_

ITEMS	QUANTITY
_____	_____
_____	_____
_____	_____
_____	_____
_____	_____
_____	_____

# Shell & Tube Heat Exchanger

## 6" Diameter Liquid to Liquid

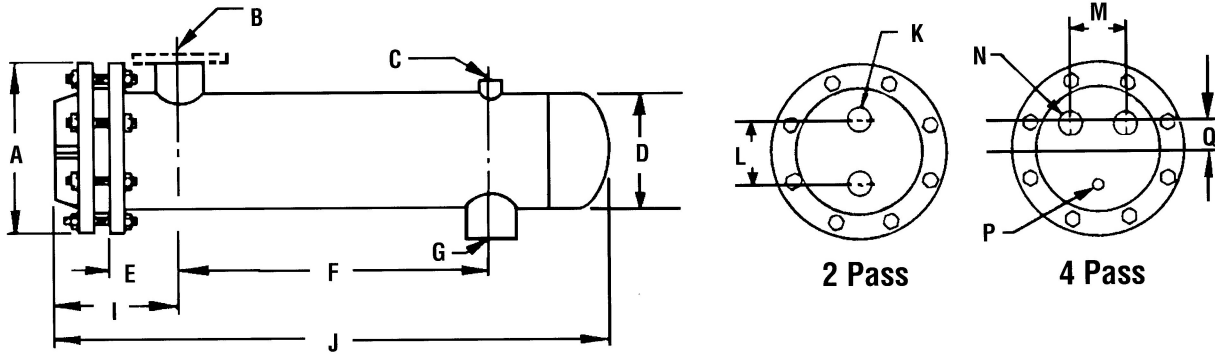

Model	A	B	C	D	E	F	G	I	J	K	L	M	N	P	Q
WW624(*)A	11	2 1/2 T	1/4	6 5/8	5	13	2 1/2 T	8 7/16	28 7/16	2 T	4	3 3/4	1 1/2 T	1/2	1 1/4
WW636(*)A		2 1/2 T				25	2 1/2 T		40 7/16						
WW648(*)A		2 1/2 T				37	2 1/2 T		52 7/16						
WW660(*)A		2 1/2 T				49	2 1/2 T		64 7/16						
WW672(*)A		2 1/2 T				61	2 1/2 T		76 7/16						
WW684(*)A		2 1/2 T				73	2 1/2 T		88 7/16						
WW696(*)A		2 1/2 T				85	2 1/2 T		100 7/16						
WW6108(*)A		2 1/2 T				97	2 1/2 T		112 7/16						

### Materials of Construction

Description	Standard	Optional
Head	4" - 10" Cast Iron 12" 20" Fabricated Steel	Bronze
Shell	Steel	—
Tubesheet	Steel	Bronze
Tubes	3/4" x 20" BGW Copper	90/10 CUNI
Baffles	Steel	Brass
Tie Rods and Spacers	Steel	Brass
Nuts and Bolts	Steel	—

### Maximum Operating Conditions

Tubeside	150 PSI
Shellside Working Pressure	150 PSI
Hydrostatic Test Pressure - Tubeside	300 PSI
Hydrostatic Test Pressure - Shellside	300 PSI
Maximum Temperature	375°F

Built in accordance with ASME Code Section VIII, Division I.

(\*) Indicates number of passes.

Dimensions are subject to change without notice, please confirm actual dimensions with factory at time of order.

JOB NAME \_\_\_\_\_  
 LOCATION \_\_\_\_\_  
 \_\_\_\_\_  
 \_\_\_\_\_  
 CONTRACTOR \_\_\_\_\_  
 CONTRACTOR P.O. NO. \_\_\_\_\_

ITEMS	QUANTITY
_____	_____
_____	_____
_____	_____
_____	_____
_____	_____



1005 E. Houston  
 Broken Arrow, OK 74012  
 Toll Free: 866-204-5229  
 PH: 918-317-0401  
 FAX: 918-317-0407  
 www.wheatleyhvac.com  
 e-mail: sales@globalflowproducts.com