

# AIR SEPARATOR (Tangential Design)

## (less strainer)

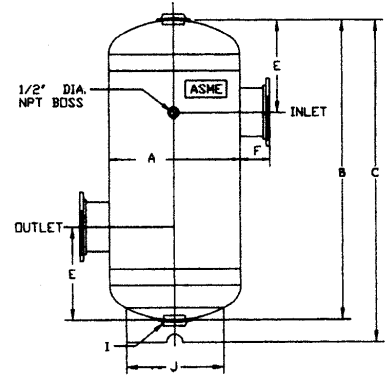
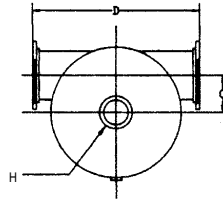

INLET/OUTLET ON TAS-002 AND TAS-025 ARE MALE-THREADED PIPE CONNECTIONS.  
ALL OTHER UNITS FLANGE CONNECTIONS-  
8" & UNDER 150# P.S.I. FLANGE CONNECTION  
10" & LARGER 125# P.S.I. FLANGE CONNECTION

PART NUMBER	INLET & OUTLET	A(IN.)	B(IN.)	C(IN.)	D(IN.)	E(IN.)	F(IN.)	G(IN.)	H(IN.)	I(IN.)	J(IN.)	WEIGHT
TAS002	2"	12	19 1/2	22 1/2	16 5/8	5 1/2	2 1/8	4 5/16	1 1/4	1	9 1/2	40
TAS025	2 1/2"	12	19 1/2	22 1/2	16 5/8	5 1/2	2 3/8	4 1/16	1 1/4	1	9 1/2	44
TAS003	3"	12	19 1/2	22 1/2	19 3/4	5 3/4	2 1/2	3 3/4	1 1/4	1	9 1/2	52
TAS004	4"	14	29	32	21 3/4	9 1/8	2 1/2	4 1/4	1 1/2	2	11 1/2	94
TAS005	5"	14	29	32	21 3/4	9 1/8	2 1/2	3 3/4	1 1/2	2	11 1/2	116
TAS006	6"	20	41	44	28	13 1/4	2 1/2	6 1/4	2	2	18	201
TAS008	8"	20	41	44	28	13 1/4	3	5 3/16	2	2	18	296
TAS010	10"	30	58	60 1/2	41	19	3 1/2	9 1/8	2	2	24	560
TAS012	12"	30	58	60 1/2	41	19	3 1/2	8 1/8	2	2	24	665
TAS140	14"	36	75 1/2	78	46 3/8	22	3 1/2	10 3/16	2	2	30	910
TAS160	16"	48	100	108	60	30	3 5/8	12 1/2	2	2	38	2200
TAS180*	18"	54	116	124	66	33	3 5/8	13 5/8	2	2 1/2	44	2500
TAS200*	20"	60	130	138	72	35	7	16	2	2 1/2	50	3800
TAS240*	24"	72	152	160	84	40	8	19	2	2 1/2	62	7000
TAS300*	30"	72	142	150	84	38	6	19 7/8	2	2	62	7450

\* Non-Stock Items Larger sizes can be fabricated to meet your needs. Please contact us.

**USE:** For removal of entrained air in hydronic and pumping systems.

**SPECIFICATION:**

Carbon Steel Construction  
Primed & Painted Exterior

Maximum Temperature 375° F  
A.S.M.E. Section VIII, Division I, stamped with documentation

*For automatic air removal, we recommend adding our high capacity air vent part #AR-075  
Cast Iron Body and Cover with Stainless Steel Internal Float and Assembly*

Dimensions are subject to change without notice, please confirm actual dimensions with factory at time of order.



JOB NAME \_\_\_\_\_  
LOCATION \_\_\_\_\_  
\_\_\_\_\_  
CONTRACTOR \_\_\_\_\_  
CONTRACTOR P.O. NO. \_\_\_\_\_

ITEMS	QUANTITY
_____	_____
_____	_____
_____	_____
_____	_____
_____	_____

**PRESSURE DROP CHART AIR SEPARATOR (less strainer)**

