

Water Pressure Reducing Valve

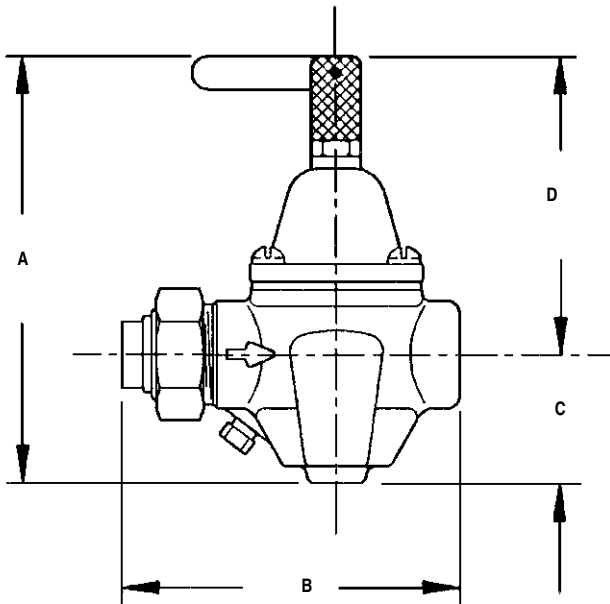

Model WPR0050S & WPR0050

Features:

- Reduces city water pressure to desired system pressure
- Automatically feeds water when pressure in a system drops below the setting of the valve
- Cast iron or bronze construction
- Easily and quickly serviced without removing valve from line
- Integral strainer
- Adjustable pressure range of 10-70 psig; factory set at 45 psig
- Maximum working pressure of 400 psig
- Maximum operating temperature of 180°F

Dimensions:

Model	Material	Size	A	B	C	D	Wt. (lbs.)
WPR0050S	Cast Iron	1/2" Sweat	5 5/16"	4 1/16"	1 5/8"	4 5/16"	2.2
WPR0050	Cast Iron	1/2" NPT	5 5/16"	4 1/16"	1 5/8"	4 5/16"	2.2
WPR0075	Bronze	3/4" NPTF	5 13/32"	4 15/32"	1 3/64"	4 11/32"	2.0

JOB NAME _____
 LOCATION _____

 CONTRACTOR _____
 CONTRACTOR P.O. NO. _____

ITEMS	QUANTITY
_____	_____
_____	_____
_____	_____
_____	_____
_____	_____
_____	_____



1005 E. Houston
 Broken Arrow, OK 74012
 Toll Free: 866-204-5229
 PH: 918-317-0401
 FAX: 918-317-0407
 www.wheatleyhvac.com
 e-mail: sales@globalflowproducts.com